

OPERATOR'S MANUAL

NP409W01-1

INCLUDING: SPECIFICATIONS, PUMP DATA, SERVICE KITS
INCLUDE MANUALS: Refer to list below.

RELEASED: 3-26-99
REVISED: 9-22-00
(REV. A)

NP409W01-1 WALL MOUNTED TRANSFER SYSTEM

SERVICE KITS

- Use only genuine ARO® replacement parts to assure compatible pressure rating and longest service life.
- **61268** for repair of 65444-2-B air motor section. Service Note: The air motor Service / Parts Manual is not shipped with the pump but is included with each service kit. If this Service / Parts information is needed, request the Air Motor Operator's Manual from ARO (manual 6544X-X, PN 97999-064).
- **637010-4** for repair of 65108-4 lower pump section.
637011 for replacement of lower ball check.
- **7102** for repair of H254SS-120-A valve.
116572 for repair of H254SS-120-A valve.
- **104181** for the repair of L26241-100 lubricator.
- **104179** for repair of P29241-100 filter / regulator.

SPECIFICATIONS

Model Series	NP409W01-X
System Type	Air Operated, Two Ball, Wall Mounted Pump
Basic Pump	650408-2-B
Ratio	9:1
Air Motor	65444-2-B
Motor Diameter	4-1/4" (10.8 cm)
Stroke (Double Acting)	4" (10.2 cm)
Air Inlet	1/2 - 14 n.p.t.f. (female)
Lower Pump End	65108-4
Material Inlet	1-1/4 - 11-1/2 n.p.s.m. (female)
Material Outlet	3/4 - 14 n.p.t.f. (female)
Dimensional Data	See page 2.
Weight	47 lbs (21.3 kg)

PERFORMANCE

Air Inlet Pressure Range	0 - 150 p.s.i. (0 - 10.3 bar)
Fluid Pressure Range	0 - 1350 p.s.i. (0 - 93.1 bar)
Max. Rec'd Cycles / Minute	75
Displacement In ³ Per Cycle	11
Volume / Cycle	6.09 oz. (180.20 ml)
Cycles Per Gallon	21
Flow @ 75 Cycles / Minute	3.57 g.p.m. (13.52 l.p.m.)
Noise Level @ 60 p.s.i. - 40 c.p.m.	① 80.0 db(A)②

① Tested with 91790 silencer installed.

② The pump sound pressure level has been updated to an Equivalent Continuous Sound Level (L_{Aeq}) to meet the intent of ANSI S1.13-1971, CAGI-PNEUROPS S5.1 using four microphone locations.

OPERATING AND SAFETY PRECAUTIONS

⚠ WARNING READ THE GENERAL INFORMATION MANUAL INCLUDED FOR OPERATING AND SAFETY PRECAUTIONS AND OTHER IMPORTANT INFORMATION.

PUMP DATA

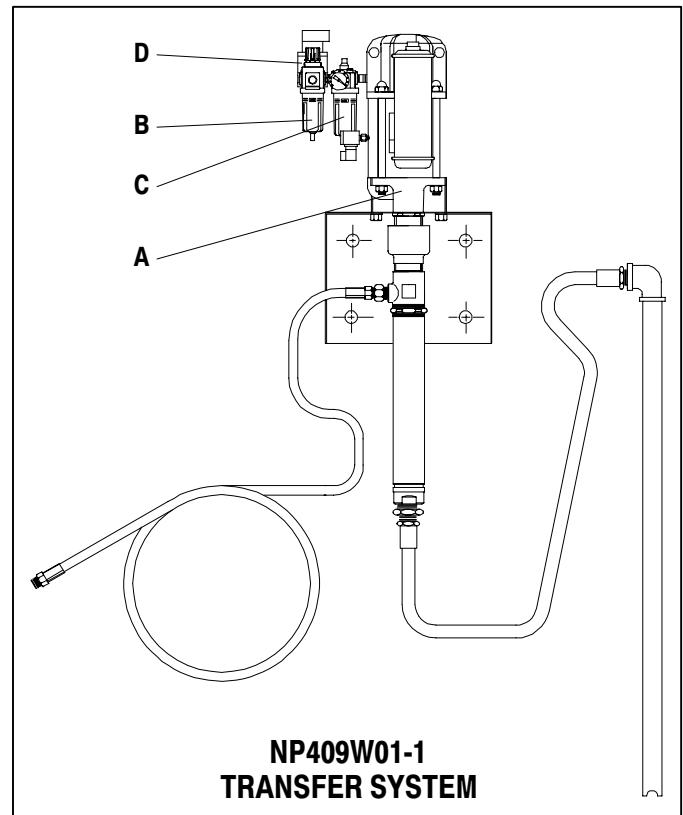

NP409W01-1
TRANSFER SYSTEM

MAJOR COMPONENTS

ITEM	DESCRIPTION (Size in Inches)	QTY	PART NO.
A	Pump Assembly	(1)	650408-2-B
B	Piggyback Filter / Regulator	(1)	P29241-100
C	Lubricator	(1)	L26241-100
D	3-Way Valve	(1)	H254SS-120-A

GENERAL DESCRIPTION

This Wall Mounted Transfer System includes pump and mounting bracket. Intended for use in general Paint Spray applications.

IMPORTANT

Operator's Manuals: This is one of the eight documents which support the various components of the system. Replacement copies are available upon request.

- NP409W01-1 MODEL OPERATOR'S MANUAL
- 650408-B PUMP (97999-022)
- GENERAL INFORMATION - PUMPING SYSTEMS (97999-636)
- 65106-X LOWER PUMP END (97999-578)
- L262X1-XXX LUBRICATOR (100400-007)
- P292X1-XXX PIGGYBACK FILTER / REGULATOR (100400-008)
- "H" SERIES VALVES (119999-37)
- 6544X-X AIR MOTOR (97999-064)



NP409W01-1 PARTS LIST

ITEM	DESCRIPTION (Size in Inches)	QTY	PART NO.
1	Gauge (0 - 160 p.s.i.)	(1)	100067
2	Solenoid Connector	(2)	CDW
3	Nipple (1/2 - 14 n.p.t. x 1-1/2" long)	(3)	Y27-54-C
4	Muffler	(1)	91790-ZZ
5	Switch	(1)	104196
6	Hose Adapter (1/8 n.p.t. male x 1/4 n.p.t. female)	(1)	32377
7	Cap Screw (3/8" - 16 x 3/4")	(4)	Y6-63-C
8	Washer (7/16" i.d.)	(4)	Y13-6-C

ITEM	DESCRIPTION (Size In Inches)	QTY	PART NO.
9	Lock Washer (3/8")	(4)	Y14-616
10	Wall Mounting Bracket Assembly	(1)	66100
11	Reducing Bushing (1-1/4 [m] x 1 [f] n.p.t.)	(1)	95987848
12	Suction Hose (1" i.d. x 10' long)	(1)	622702-10
13	90° Elbow (1 - 11-1/2 n.p.t.)	(1)	Y43-16-S
14	Suction Tube (1 - 11-1/2 n.p.t.f. - 1)	(1)	94415-1
15	Hose, Teflon Lined (3/4" i.d. x 10' long)	(1)	623600-10
16	90° Street Elbow (1/4 - 18 n.p.t.)	(1)	Y43-2-C

