

Model: ALH 80



24.10.2008

Technical Datasheet

Weight 900.0Kg	
L.Hose 2910.0 mm	
D.Hose 80.0 mm	
Dim.	mm
A	262.00
B	876.00
C	803.00
D	555.00
E	1320.00
F	690.00
G	830.00
H	345.00
I	1300.00
J	1400.00
K	27.00
L	-
M	140.50
N	145.00
O	Flange DN80 PN16
P	210.00
Q	345.00

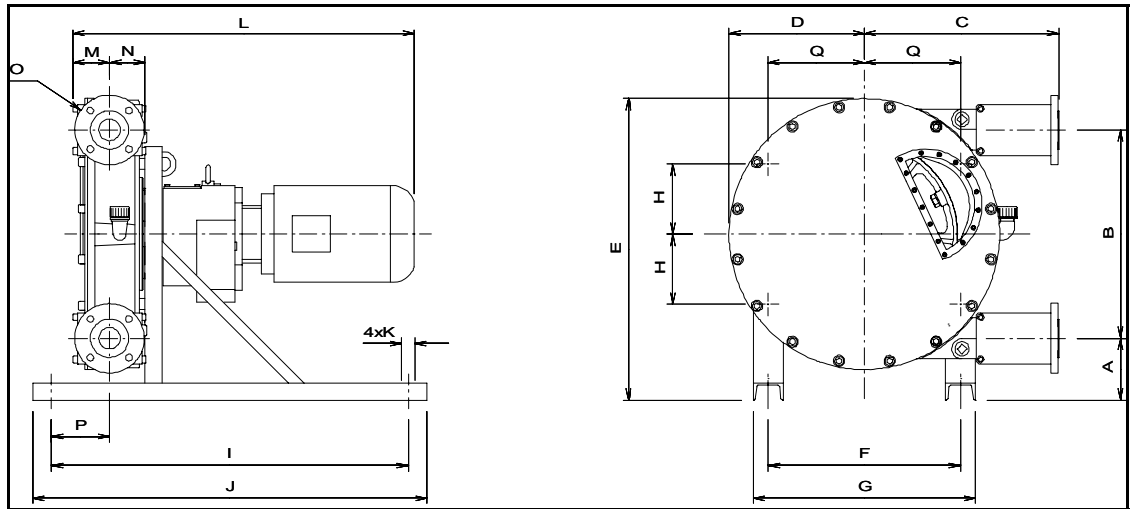

Shims Table

Pressure in bar (psi)	Speed in rpm	Number of shims
dP < 5 (72,5)	0 a 20	0
	20 a 60	0
5 (72,5) < dP < 7,5 (108,75)	0 a 20	2
	20 a 47	1
7,5 (108,75) < dP < 10	0 a 20	3
	20 a 37	2
10 (145) < dP < 15 (217,5)	0 a 20	4
	20 a 31	3

- Continuous
- *Intermittent
- Forbidden

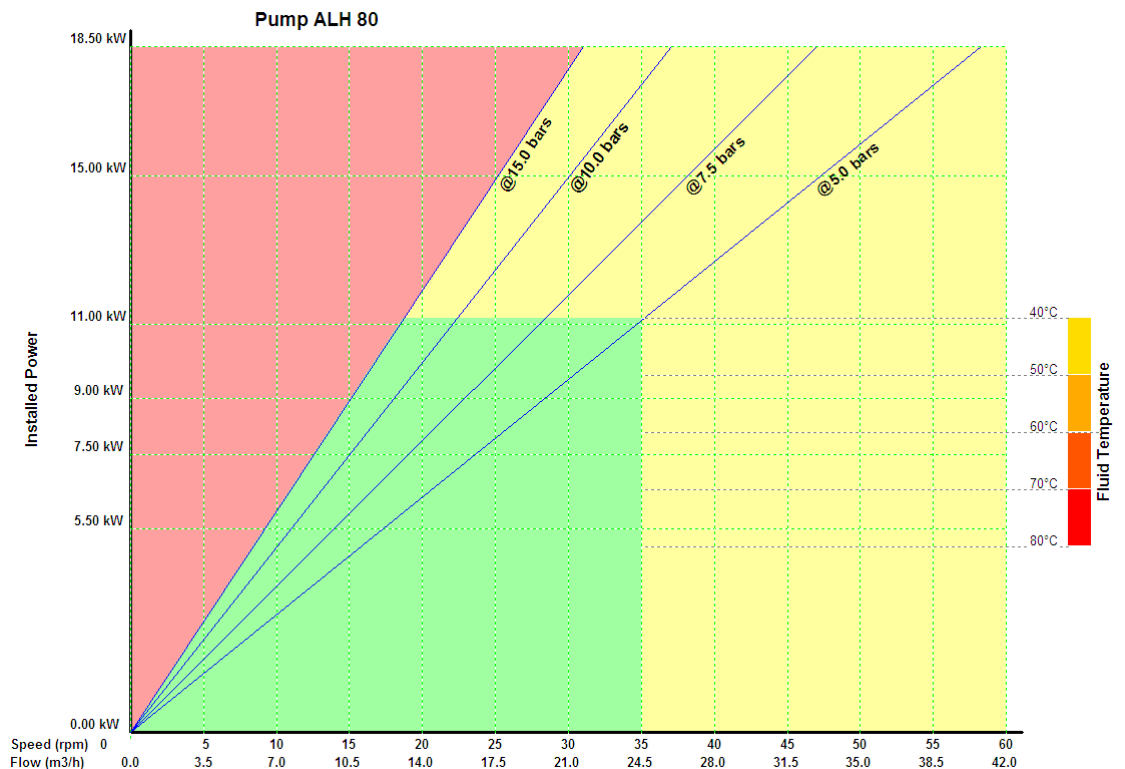

ALBIN PUMP SAS
 ZAC de Fontgrave
 F-26740 Montboucher
 Tél: + 33 4 75 90 92 92
 Fax: + 33 4 75 90 92 40
 www.albinpump.fr
 www.albinpump.com

*Intermittent use is 2 hours max. continuous duty followed by 1 hour stop