



# Model: ALH 32

## Technical Datasheet

24.10.2008

<b>Weight 150.0Kg</b>	
<b>L.Hose 1300.0 mm</b>	
<b>D.Hose 32.0 mm</b>	
Dim.	mm
A	122.50
B	330.00
C	435.50
D	238.00
E	525.50
F	426.00
G	476.00
H	157.75
I	770.00
J	810.00
K	13.00
L	-
M	84.00
N	71.00
O	Flange DN32 PN16
P	109.00
Q	157.75

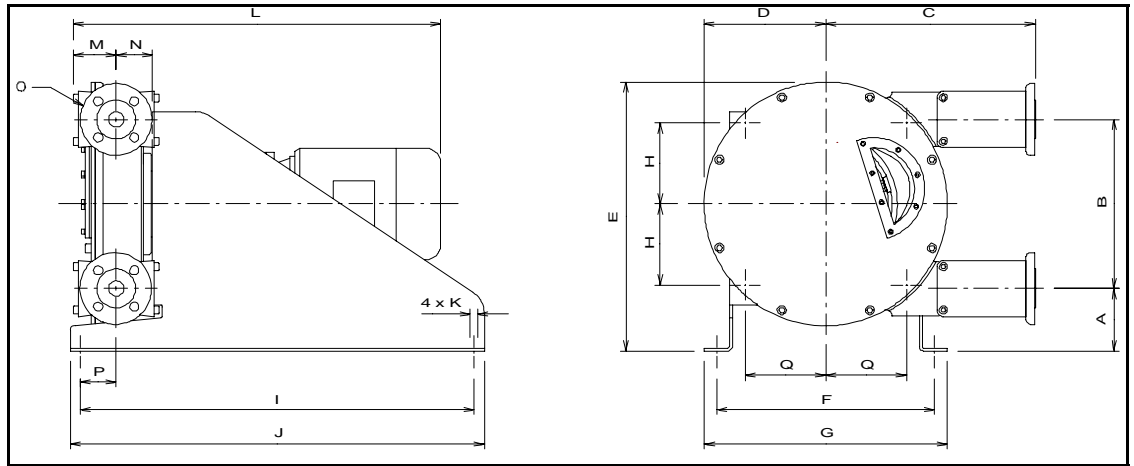

Shims Table

Pressure in bar (psi)	Speed in rpm	Number of shims
dP < 5 (72,5)	0 a 45	0
	40 a 140	0
5 (72,5) < dP < 7,5 (108,75)	0 a 45	2
	45 a 140	1
7,5 (108,75) < dP < 10	0 a 45	3
	45 a 110	2
10 (145) < dP < 15 (217,5)	0 a 45	4
	45 a 80	3

- Continuous
- \*Intermittent
- Forbidden

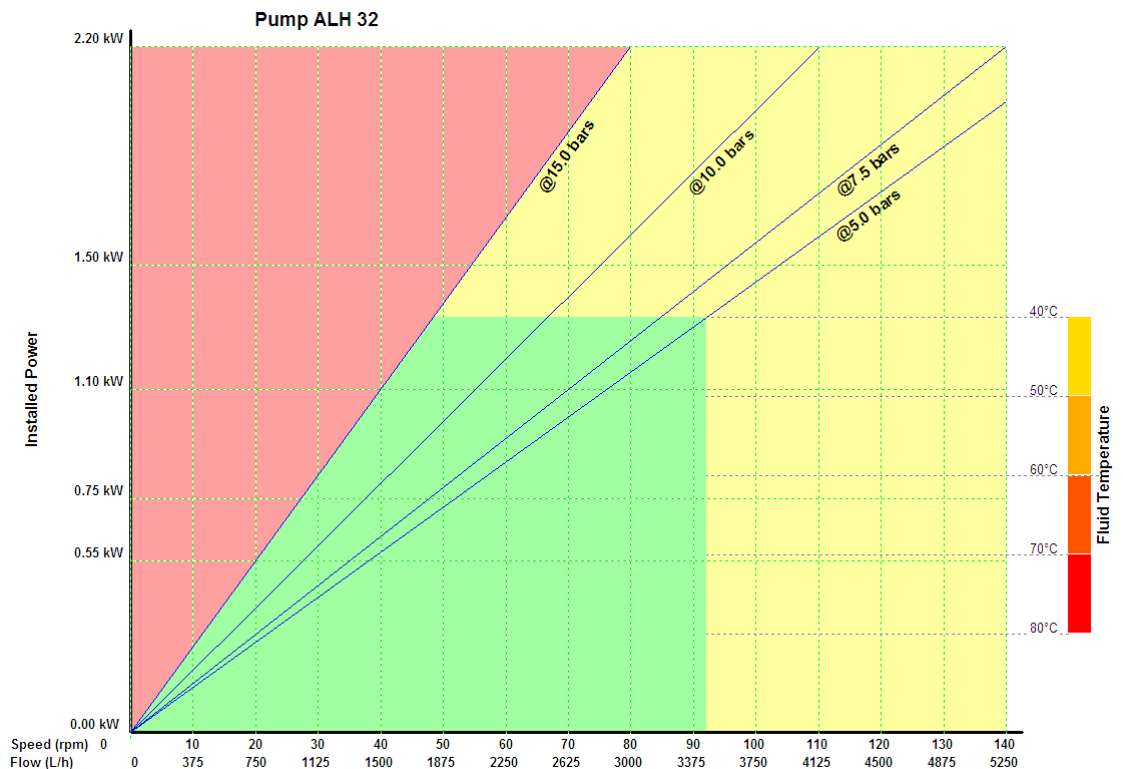

ALBIN PUMP SAS  
 ZAC de Fontgrave  
 F-26740 Montboucher  
 Tél: + 33 4 75 90 92 92  
 Fax: + 33 4 75 90 92 40  
 www.albinpump.fr  
 www.albinpump.com

\*Intermittent use is 2 hours max. continuous duty followed by 1 hour stop