



Model: ALH 25

Technical Datasheet

24.10.2008

Weight 105.0Kg	
L.Hose 1090.0 mm	
D.Hose 25.0 mm	
Dim.	mm
A	95.00
B	262.00
C	355.50
D	190.00
E	416.00
F	311.00
G	351.00
H	110.00
I	560.00
J	600.00
K	13.00
L	-
M	65.00
N	79.00
O	Flange DN25 PN16
P	61.00
Q	110.00

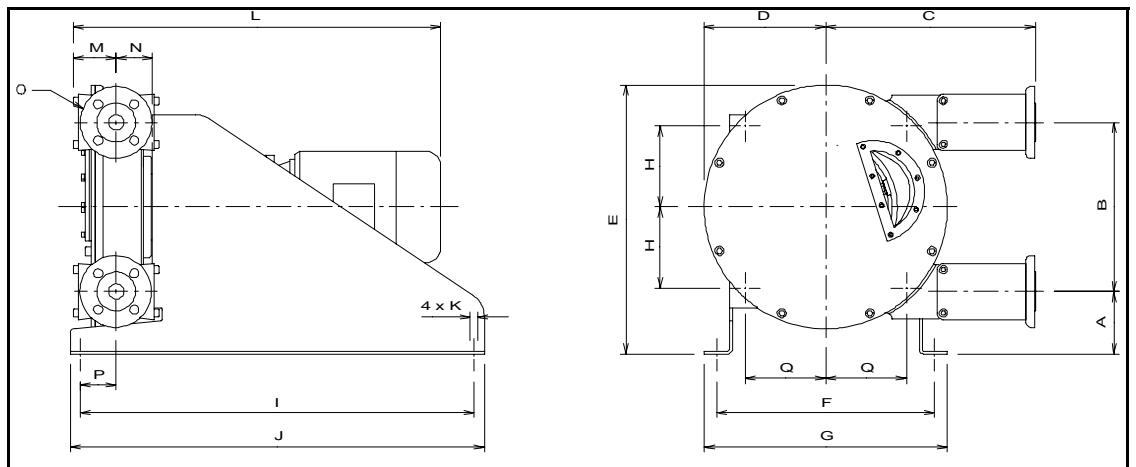

Shims Table

Pressure in bar (psi)	Speed in rpm	Number of shims
dP < 5 (72,5)	0 a 40	0
	40 a 160	0
5 (72,5) < dP < 7,5 (108,75)	0 a 40	2
	40 a 125	1
7,5 (108,75) < dP < 10	0 a 40	3
	40 a 105	2
10 (145) < dP < 15 (217,5)	0 a 40	4
	40 a 90	3

- Continuous
- *Intermittent
- Forbidden

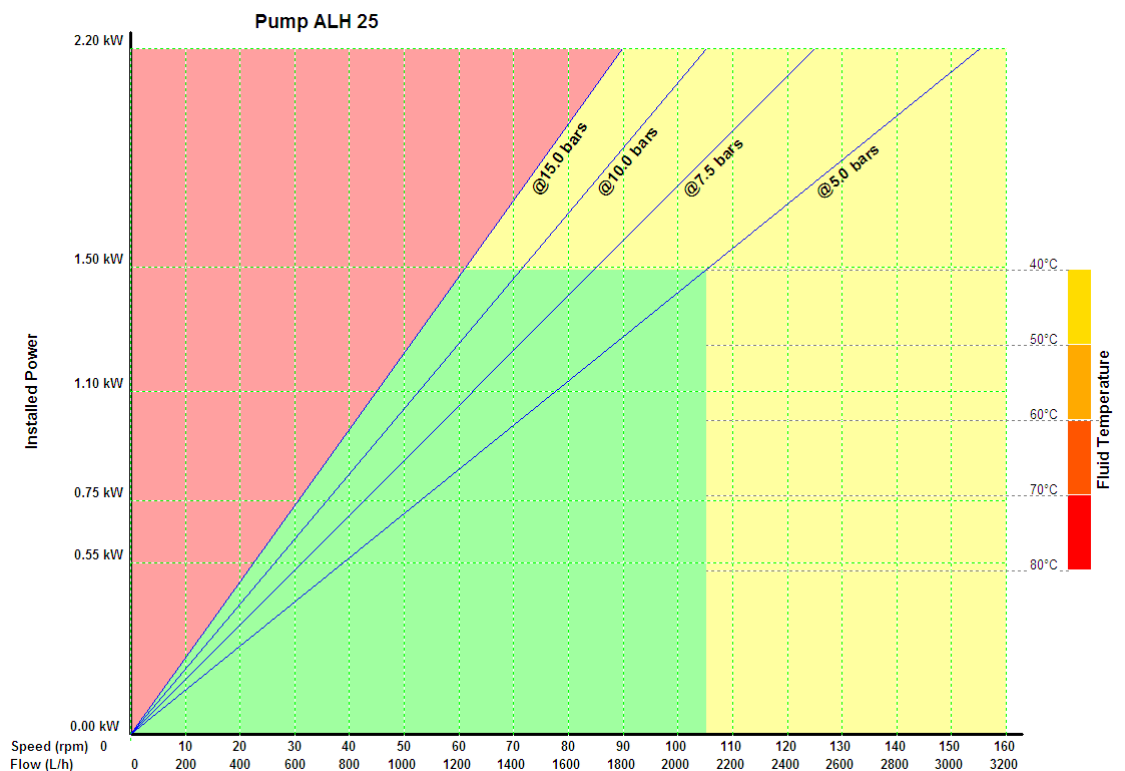

ALBIN PUMP SAS
 ZAC de Fontgrave
 F-26740 Montboucher
 Tél: + 33 4 75 90 92 92
 Fax: + 33 4 75 90 92 40
 www.albinpump.fr
 www.albinpump.com

*Intermittent use is 2 hours max. continuous duty followed by 1 hour stop